

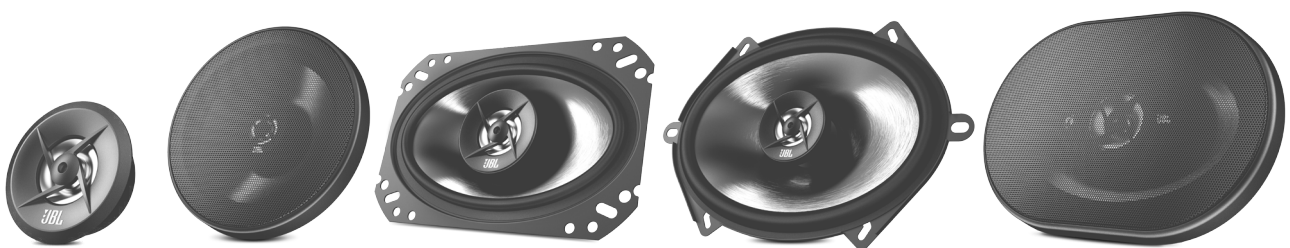

# Stage Speakers

Impressive performance, amazing price.



## Great sound doesn't have to be expensive.

Stage Series coaxial and component speakers make signature JBL performance remarkably inexpensive. Polypropylene woofers provide a strong foundation of bass and midrange frequencies, and PEI balanced dome tweeters complete the full-range sound with crisp, high-end frequencies. It's a lot of great sound, for not a lot of money. Available in a range of standard sizes – 5-1/4", 6-1/2", 6" x 8" and 4" x 6" coaxial, 6" x 9" 3-way and 6-1/2" component – Stage Series speakers are ideal, entry-level upgrades from factory speakers. They deliver the perfect blend of uncompromising JBL sound and unbeatable value.

## Features

- ▶ Injection-molded polypropylene cone
- ▶ PEI balanced dome tweeter
- ▶ Piezoelectric supertweeter
- ▶ Affordable pricing

## Features and Benefits

### Injection-molded polypropylene cone

The polypropylene woofer cone in Stage speakers is engineered for superior rigidity and sensitivity. The result is increased low-frequency output and richer, more robust musical character.

### PEI balanced dome tweeter

Polyetherimide tweeters offer increased power handling, efficiency and reduced distortion for smooth, spacious sound, and a seamless transition between the middle and high frequencies.

### Piezoelectric supertweeter

In addition to a PEI balanced dome tweeter, the Stage 9603 three-way speaker adds a piezoelectric supertweeter for even greater definition in high-frequency ranges.

### Affordable pricing

Stage Series speakers provide great JBL sound at a great price. Available in standard sizes, they offer car audio lovers an affordable upgrade from factory speakers.

## What's in the Box

### Stage 402

1 pair of dual cone speakers  
Owner's manual

### Stage 502

1 pair of coaxial speakers  
8 mounting screws  
Owner's manual

### Stage 602

1 pair of coaxial speakers  
1 pair of speaker grilles  
8 mounting screws  
Owner's manual

### Stage 6402

1 pair of coaxial speakers  
8 mounting screws  
Owner's manual

### Stage 8602

1 pair of coaxial speakers  
8 mounting screws  
Owner's manual

### Stage 9603

1 pair of 3-way speakers  
1 pair of speaker grilles  
8 mounting screws  
Owner's manual

### Stage 600C

1 pair of woofers  
1 pair of tweeters  
1 pair of speaker grilles  
8 mounting screws  
Owner's manual

## Technical Specifications

### Stage 402

- ▶ Description: 4" (100mm) dual cone car speaker
- ▶ Power Handling: 20W RMS, 60W peak
- ▶ Sensitivity (@ 2.83V): 85dB
- ▶ Frequency Response: 80Hz – 15kHz
- ▶ Impedance: 4 ohms

### Stage 502

- ▶ Description: 5-1/4" (130mm) coaxial car speaker
- ▶ Power Handling: 35W RMS, 105W peak
- ▶ Sensitivity (@ 2.83V): 91dB
- ▶ Frequency Response: 70Hz – 20kHz
- ▶ Impedance: 4 ohms

### Stage 602

- ▶ Description: 6-1/2" (165mm) coaxial car speaker
- ▶ Power Handling: 45W RMS, 135W peak
- ▶ Sensitivity (@ 2.83V): 91dB
- ▶ Frequency Response: 55Hz – 20kHz
- ▶ Impedance: 4 ohms

### Stage 6402

- ▶ Description: 4" x 6" (101mm x 152mm) coaxial car speaker
- ▶ Power Handling: 35W RMS, 105W peak
- ▶ Sensitivity (@ 2.83V): 90dB
- ▶ Frequency Response: 75Hz – 20kHz
- ▶ Impedance: 4 ohms

### Stage 8602

- ▶ Description: 6" x 8" (152mm x 203mm) coaxial car speaker
- ▶ Power Handling: 60W RMS, 180W peak
- ▶ Sensitivity (@ 2.83V): 91dB
- ▶ Frequency Response: 20Hz – 20kHz
- ▶ Impedance: 4 ohms

### Stage 9603

- ▶ Description: 6" x 9" (152mm x 229mm) three-way car speaker
- ▶ Power Handling: 70W RMS, 210W peak
- ▶ Sensitivity (@ 2.83V): 92dB
- ▶ Frequency Response: 45Hz – 20kHz
- ▶ Impedance: 4 ohms

### Stage 600C

- ▶ Description: 6-1/2" (165mm) car audio component system
- ▶ Power Handling: 50W RMS, 150W peak
- ▶ Sensitivity (@ 2.83V): 90dB
- ▶ Frequency Response: 50Hz – 20kHz
- ▶ Impedance: 4 ohms